

MODEL: JKPLAST

- Pogodni su za izvlačenje agresivnih gasova (hemijska industrija, laboratorije, biološka proučavanja, podzemni tuneli, itd.).
- U potpunosti izrađeni od PVC-a; radno kolo sa unapred zakrivljenim lopaticama (tipa sirocco).
- Materijali i dizajn obezbeđuju otpornost na koroziju i varničenje.
- Visoko kvalitetan elektromotor specijalno projektovan za ventilatore, montiran je na antivibracione gumene nosače, zaštita motora je IP55 klase F. Napajanje: 220V-50Hz ili 380V-50Hz.
- Regulisanje monofaznih modela se vrši reostatom (modeli 25/6LP; 012/4LP i 12/2LP reostatom REM 2,5N; modeli 30/6LP i 20/4LP reostatom REM 5; modeli 25/4LP; 30/4LP i 20/2LP reostatom REM 10). Za sve trofazne modele obavezna je regulacija frekventnim regulatorom.

■ Suitable for oxidant gas suction (chemical industries, laboratories, biological studies, undergrounds, etc).

■ Wholly made of Polypropylene; Impeller with forward curved blades (sirocco type).

■ The material and design make the fan corrosion and spark proof.

■ High quality electric motor specially manufactured for fans, mounted on anti-vibration rubber feet; protection IP55-Class F. Input voltage: 220V-50Hz or 380V-50Hz.

■ Single phase models regulation with speed controller (models 25/6LP; 012/4LP and 12/2LP with REM 2,5N; models 25/6LP; 30/6LP and 20/4LP with REM 5; models 25/4LP; 30/4LP and 20/2LP with REM 10).

Three phase models must be driven with frequency inverter.



JAKKA®

MODEL: JKPLAST

Tehničke karakteristike / Technical Characteristics 900 o/min / rpm

Type	Power	Inlet Flange Ø	Air flow	Static Pressure	Noise Level
	HP	mm	m³/h	mm H₂O	dB (A)
JKPLAST - 25/6 - OP - LP	0,25	250	1.500	15	59
JKPLAST - 30/6 - OP - LP	0,50	315	2.500	22	60

MODEL: JKPLAST

Tehničke karakteristike / Technical Characteristics 1.400 o/min / rpm

Type	Power	Inlet Flange Ø	Air flow	Static Pressure	Noise Level
	HP	mm	m³/h	mm H₂O	dB (A)
JKPLAST - 12/4 - OP - LP	0,25	125	250	18	56
JKPLAST - 20/4 - OP - LP	0,50	200	950	21	57
JKPLAST - 25/4 - OP - LP	1,00	250	2.200	33	65
JKPLAST - 30/4 - OP - LP	1,50	315	4.000	50	65

MODEL: JKPLAST

Tehničke karakteristike / Technical Characteristics 2.800 o/min / rpm

Type	Power	Inlet Flange Ø	Air flow	Static Pressure	Noise Level
	HP	mm	m³/h	mm H₂O	dB (A)
JKPLAST - 12/2 - OP - LP	0,25	125	450	36	67
JKPLAST - 20/2 - OP - LP	1,50	200	1.600	100	70
JKPLAST - 25/2 - OP - LP	3,00	250	2.200	162	71



Centrifugalni plastični ventilatori sa jednim usisom / Single Inlet Plastic Centifugal Fans

JPLAST 12-20-25

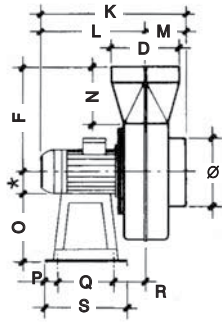
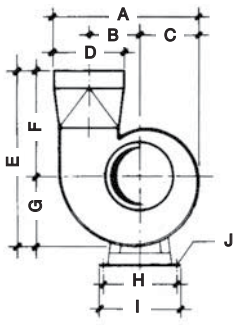

Dimenzije / Dimensions

Type	∅	A	B	C	∅D	E	F	G	H	I	J	K	L	M	N	O	P	Q	R	S
JPLAST - 12	125	284	103	118	125	324.5	189	135.5	175	200	10	293	221	72	90	130	35	130	80	200
JPLAST - 20	200	418	148	170	200	501	300	201	215	240	10	420	300	120	160	200	35	170	95	240
JPLAST - 25	250	520	185	210	250	570	320	250	255	280	10	486.5	357.5	129	150	250	52.5	175	130	280

JPLAST 16

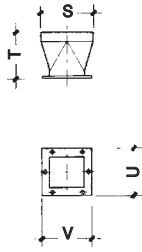
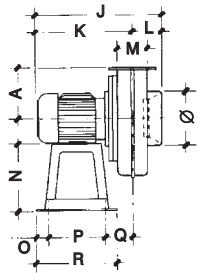
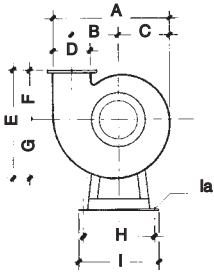

JPLAST 30-35-40

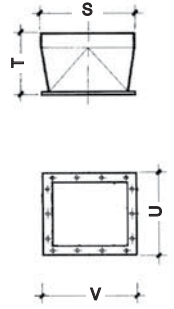
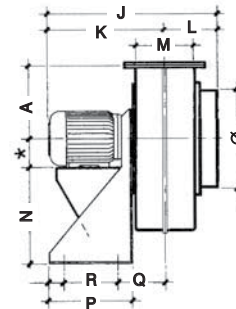
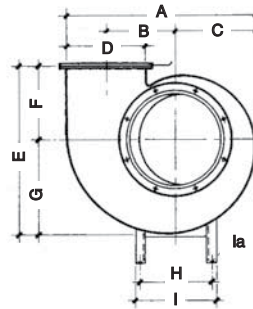

Dimenzije / Dimensions

Type	∅	A	B	C	D	E	F	G	H	I	la	J	K	L	M	N	O	P	Q	R	S	T	U	V
JPLAST - 16	160	349	139.5	157	105	325	148	177	215	240	10	367	282	85	90	200	35	170	80	240	160	120	140	150
JPLAST - 30	315	593	222	251	240	515	215	300	234	260	12	565	380	185	195	310	50	175	155	275	315	170	265	306
JPLAST - 35	335	696	259	297	280	628	275	353	285	380	12	660	450	210	225	320	50	200	170	300	355	210	305	356
JPLAST - 40	400	834.5	310	357	335	724	300	424	315	350	12	810	565	245	270	410	50	250	197	350	400	230	362	421

JPLAST 50-60-70

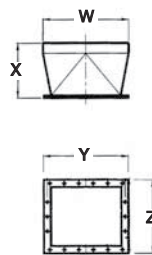
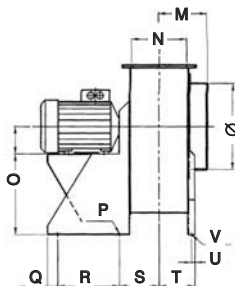
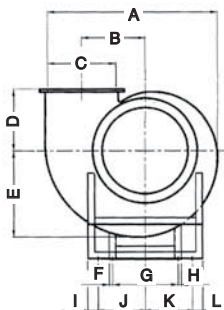

Dimenzije / Dimensions

Type	∅	A	B	C	D	E	F	G	H	I	J	K	L	M	N	O	P	Q	R	S	T	U	V	W	X	Y	Z
JPLAST - 50	500	993	370	400	358	503	20	380	20	60	275	275	60	280	320	470	14	60	360	231	208	20	14	500	230	496	426
JPLAST - 60	600	1191	444	480	426	603	25	450	25	60	335	335	60	325	385	540	14	60	360	270	250	25	14	600	400	586	505
JPLAST - 70	700	1387	518	560	492	701	25	520	25	70	385	385	70	365	450	700	14	70	350	310	285	25	14	700	460	666	570

Centrifugalni plastični ventilatori sa jednim usisom / Single Inlet Plastic Centrifugal Fans

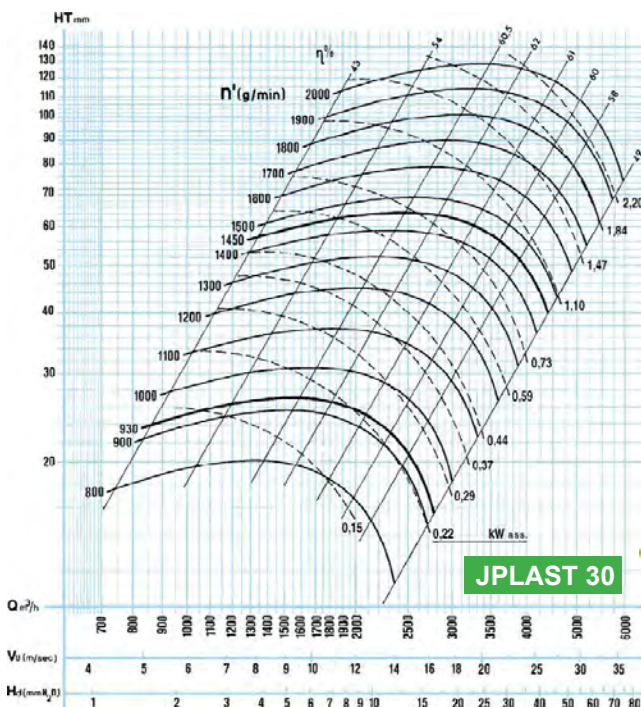
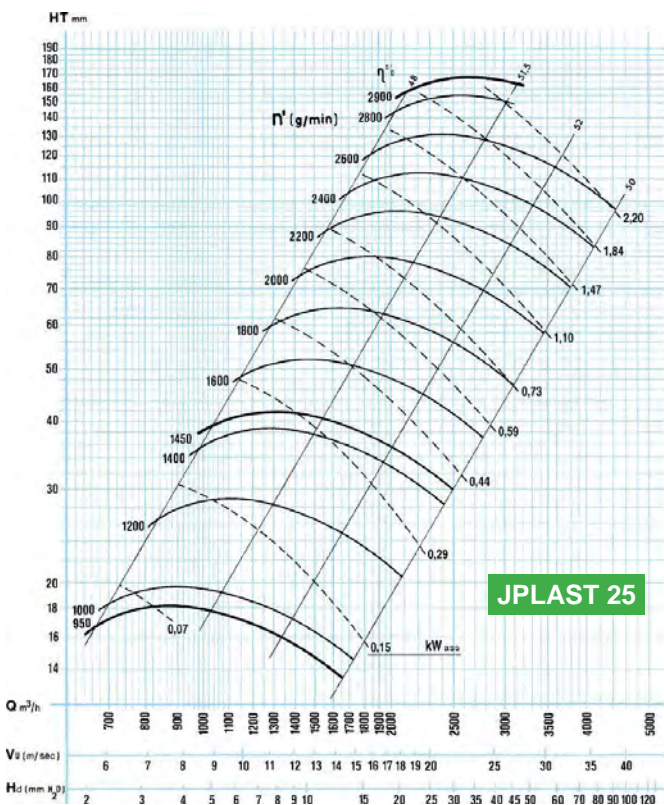
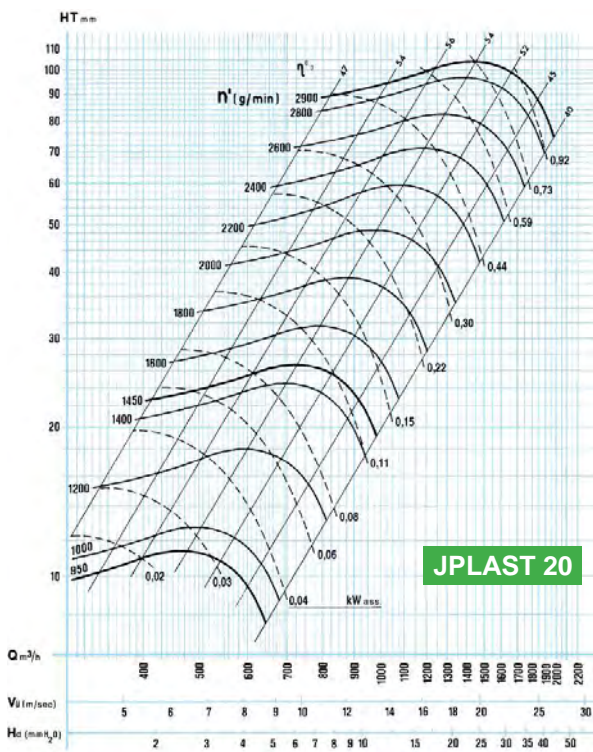
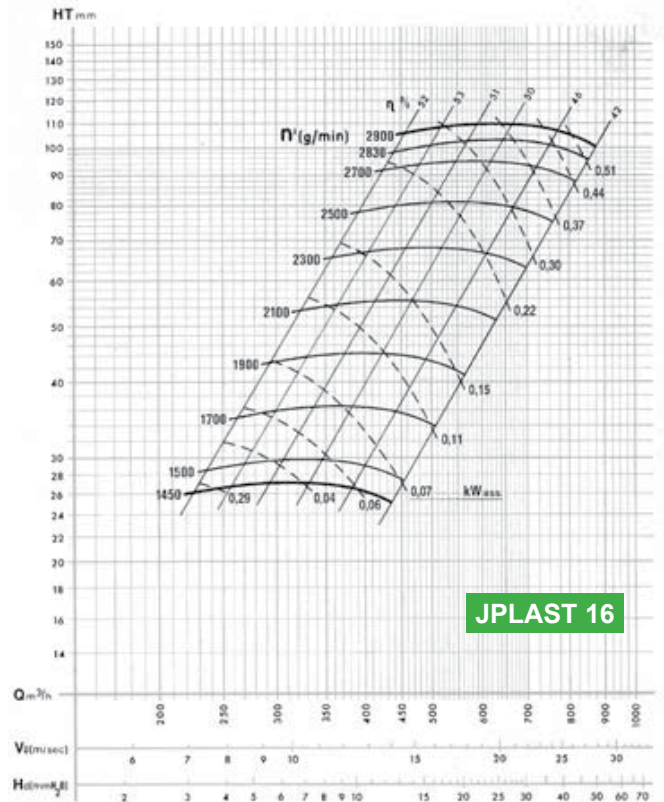
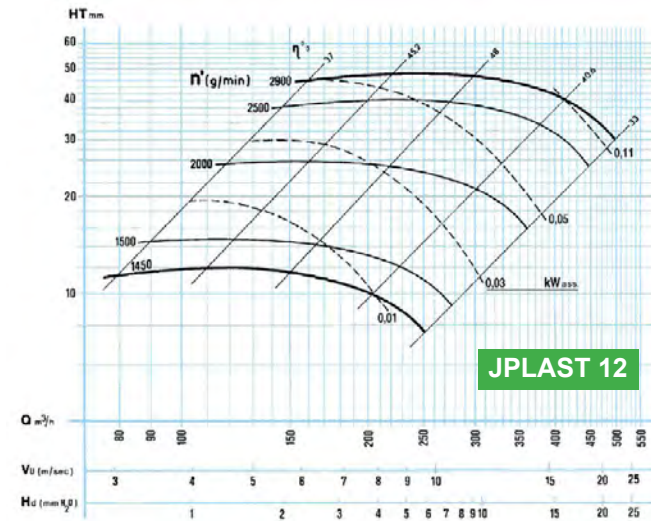

Centrifugalni plastični ventilatori sa jednim usisom / Single Inlet Plastic Centrifugal Fans

